

ANANTARA
THE MARKER · DUBLIN
HOTEL



ANANTARA THE MARKER DUBLIN HOTEL

One of Dublin's most visually architectural landmarks, Anantara The Marker Dublin Hotel offers a distinct blend of urban style and luxury. Located right in the heart of the Docklands, Dublin's most prolific cultural hub, it's the perfect base from which to explore Ireland's capital city.

Extraordinary, surprising and luxurious, Anantara The Marker Dublin Hotel is an unforgettable urban retreat for those who crave the unconventional, yet still expect the exceptional standards of service that are the signature of a member of The Leading Hotels of the World™.

| | |
|--------------|--|
| Address: | Grand Canal Square, Docklands, Dublin 2, D02 CK38, Ireland |
| Telephone: | +353 (01) 687 5100 |
| Email: | themarker@anantara-hotels.com |
| Web Address: | themarker.anantara-hotels.com |



LOCATION

Anantara The Marker offers contemporary urban luxury overlooking the Grand Canal Square's waterfront. Perfectly located in the modernised Docklands, the hotel captures the unique mix of vibrant charm and rich culture that exemplifies the spirit of modern Dublin.

Originally a significant Viking Settlement and Port, Dublin's character has been shaped by architecture spanning from Medieval to Modern times. Built by the greatest engineers of the age, the Grand Canal Docks were the final point of the Grand Canal (An Chanáil Mhór), connecting Dublin, in the east of Ireland, with the River Shannon in the west, via a series of villages and towns.

In recent years the area has developed to become one of the trendiest places to live, work and play in Dublin. It is home to the headquarters of numerous global players in the banking, legal and tech sector. With companies such as Facebook, TikTok, Google and AirBnB choosing Grand Canal Dock as their base, the futuristic area has become affectionately known as "Silicon Docks".

Management:
Ownership:
General Manager:

Anantara Hotels, Resorts & Spas
Deka Immobilien
Michael Davern



ANOTHER MILESTONE IN HISTORY

The hotel name 'The Marker' is a mark of respect for one of the greatest inland trade routes, the Grand Canal. The direct link with the exotic trading hubs of Europe, the Grand Canal's 82 miles were lined with cast iron 'markers'. These markers were like milestones, showing travellers how far they had to go until journey's end. The final marker was right where the hotel is located now, in Grand Canal Square. Inspired by the innate Irish love of adventure, travel and trade, the hotel's name embodies this rich history, giving it a new sense of place in a contemporary context.

The building's architecture draws on the elemental nature of the Irish landscape and combines it with a sleek urban aesthetic, creating an experience that is distinctly authentic and truly inimitable. Inspiration comes from the geometric shapes that exist naturally on the Irish Island, from the rugged Burren Landscape to the unique hexagonal stones of the Giant's Causeway.

This elemental style is carried right through from the stunning ground floor bar and brasserie, through the unique geometric layouts of our 187 bedrooms, to the stunning rooftop garden, reaching across the cityscape to the wild natural beauty of the mountains and the Irish Sea.



ACCOMMODATION

Most rooms and suites have striking views over Grand Canal Square and the Docklands, to the Dublin and Wicklow mountains and the Dublin Bay. Bathed in natural light, spacious and designed with supreme comfort and style, all guest rooms set a new standard in city living.

Premier Room

Premier Rooms harmonise beauty and functionality, with ergonomic furnishings and high-tech amenities designed in a sleek, contemporary style. The bespoke furniture has been crafted by Irish designers, while original artwork showcases some of the best home-grown talent. The bathroom is indulgent, with floor-to-ceiling marble creating an astonishing sanctuary, and luxurious toiletries exclusively by VOYA.

Deluxe Room

In addition to all the style and comforts of a Premier Room, the Deluxe Rooms are perfectly positioned to offer guests an impressive bird's eye view of Grand Canal Square. High-tech amenities range from an interactive entertainment system to a Nespresso Zenius machine. Make a fresh brew, then sink into an Eames-style chair or Villeroy & Boch marble bathtub.

Deluxe Room with view

The deluxe rooms highlight the hotel's outlook over Grand Canal Square and the stunning waterfront with select views of Dublin's coastline and lush mountains.

Junior Corner Suite

Corner Suites are ideal for business travellers or families, with extra space to work, lounge and rest. Natural sunlight falls on the desk with Eames-style chair, a freshly brewed espresso is at your fingertips, and cots can be added for children with space easily left over for play.

Junior Corner Suite with view

Wake up to views of water beside the bustling grand canal square, the cityscape beyond, and then the misty Wicklow Mountains in the distance. Luxury Corner Suites epitomise modern elegance, with original Irish artworks and plush colourful fabrics adorning the light space.

One Bedroom Suite

With a separate living room brimming with plush rugs, pillows and throws, a designer sofa set and original paintings, our two One Bedroom Suites are the home away from home you never had. Choose from The Roche which overlooks the iconic Convention Centre Dublin and it is named after its Dublin-born Nobel Prize architect or The Schwartz with 6th-floor Grand Canal Square view named after the square designer.



Presidential Suite

Enjoy an expansive 129 square metres (1400 sq ft.); The Presidential Suite is located on the unhampered fifth floor that boasts unobstructed views of Grand Canal Square and iconic architectural landmarks – both old and new – that make up the city’s unique fabric. Two ensuite bedrooms open onto a breakfast room and separate living room decked out in comforts from specially commissioned furnishings and art to a Nespresso machine.

Room features and amenities

- King or twin bed
- International satellite LED TV with Chromecast system
- WiFi
- Work desk with international power sockets
- Individually controlled air conditioning
- Mini bar
- Nespresso coffee machine
- Tea by Solaris
- Exclusive toiletries by VOYA

Guest services

- 24-hour Room Service
- 24-hour Business Centre for computer access and printing
- Secretarial Services
- Valet Parking
- Laundry and dry-cleaning Services

| ROOM TYPE | TOTAL | | ROOM SIZE | | ACCEPT ROLL AWAY BED | MAX GUESTS |
|-------------------------------|---------|---------|-----------|-----------|----------------------|--------------|
| | | | (SQM) | (SQFT) | | |
| Premier Room | 42 | | 30 | 325 | No | 2 |
| | 29 King | 13 Twin | | | | |
| Deluxe Room | 75 | | 30 | 325 | No | 2 + 1 infant |
| | 57 King | 18 Twin | | | | |
| Deluxe Room with views | 49 | | 30 - 35 | 325 - 375 | No | 2 + 1 infant |
| Junior Corner Suite | 14 | | 40 - 44 | 430 - 485 | Sofa bed | 3 Adults |
| | 13 King | 1 Twin | | | | |
| Junior Corner Suite with view | 4 King | | 40 - 44 | 430 - 485 | Sofa bed | 3 Adults |
| One Bedroom Suite | 2 King | | 85 - 92 | 915-990 | Yes | 3 Adults |
| Presidential Suite | 1 King | | 129 | 1400 | Yes | 4 |
| Accessible Rooms | 8 King | | 35 | 375 | No | 2 |



RESTAURANTS AND BARS

Executive Head Chef, Gareth Mullins is known for artistically crafting all menu design and food preparation in the hotel's restaurants and bars. With over 20 years' experience cooking in five-star hotels in Ireland and Australia, Gareth leads a talented team. His passion for sourcing local Irish produce is found in each recipe he creates. This passion is reflected in Gareth's Commissioner General of Eurotoques Ireland which consists of 200 of the country's best-known chefs, producers and educators with an aim to protect our Irish culinary heritage and inspire future generations.



The Marker Bar

The Marker Bar exudes its own unique style and ambience. Modern, fresh, and laid back, it draws an eclectic mix of people through its doors. The Marker Bar buzzes from morning till night – a place for work and an espresso, a light lunch or dinner and drinks with an diverse selection of gastro fare and cocktails. Summer evenings can be enjoyed with a table out on the terrace on Grand Canal Square.

Opening hours:

Monday – Thursday: 9.00 am – 11.30 pm

Friday – Saturday: 9.00 am – 12.30 am

Sunday: 9.00 am – 11.00 pm

Kitchen: 12.00 noon – 10.00 pm

Cuisine: Gastropub with Irish fare

Seating capacity: 64



The Rooftop Lounge

The rooftop flows from indoors to out, a mix of intimate and social areas. 360° views extend to the mountains on one side and the Irish Sea on the other. Relaxed all day alfresco dining moves towards a more upbeat ambience at sunset. Head up for cocktails and a sharing platter at this destination for style conscious urbanites.

Opening hours:

5.00 pm – 11.00 pm.

On Friday and Saturday October through April and every day in Summer May through September.

Cuisine: Drinks & Light Bites

Seating capacity: 130



In-Room Dining

Offering gourmet flavours at any time of the day or night, the in-room dining menu offers guests fresh, Irish dishes. From breakfast in bed, a healthy snack, midnight munchies or a sinfully indulgent dessert, relax in comfort and let us bring a dinner experience to your room.

Opening hours: 24 hours daily



CONFERENCE AND MEETING FACILITIES

Anantara The Marker is your choice for events infused with authentic local colour and a range of customised experiences. With capacities ranging for 10 to 350 people, the hotel offers a unique backdrop for small-to-large scale meetings, events and conferences. The eight state-of-the-art meeting rooms are visually impressive and include video conferencing, multi-media equipment, LCD displays, WiFi and air-conditioning. Most meeting spaces boast natural daylight, looking out onto Chimney Park, an iconic landmark and a surprising hidden treasure, tucked into the contrasting urban landscape. Three of the rooms have direct own-door access to Chimney Park, creating even more flexibility.

Dedicated meeting and event coordinators ensure every element flows seamlessly, from VIP welcome gifts and the ideal music, themed decor and entertainment, to innovative catering options and impeccable service to enrich the experience.

| MEETING ROOM | AREA (SQM) | DIMENSIONS (IN M LxWxH) | BANQUET | BOARD-ROOM | CLASS-ROOM | COCKTAIL | U-SHAPE | THEATRE | CABARET | DAYLIGHT |
|----------------|------------|-------------------------|---------|------------|------------|----------|---------|---------|---------|----------|
| The Marker One | 177 | 12 x 14 x 4.7 | 110 | 34 | 102 | 190 | 43 | 150 | 80 | No |
| The Marker Two | 177 | 12 x 14 x 4.7 | 110 | 34 | 88 | 160 | 43 | 130 | 70 | No |
| combined | 354 | 12 x 28 x 4.7 | 240 | 68 | 180 | 350 | 86 | 300 | 170 | No |
| The Carnac | 29.7 | 5.4 x 5.5 x 2.7 | 10 | 12 | 15 | 23 | 12 | 23 | 8 | Yes |
| The Hamilton | 27.5 | 5.4 x 5.1 x 2.7 | 10 | 10 | 6 | - | 10 | 16 | 8 | No |
| combined | 57.2 | 5.4 x 10.6 x 2.7 | 24 | 24 | 22 | 58 | 22 | 42 | 21 | Yes |
| The Omer | 48.2 | 5.4 x 10.6 x 2.7 | 10 | 8 | 8 | 23 | 10 | 25 | 8 | Yes |
| The Broadstone | 26.2 | 4.9 x 5.35 x 2.7 | 10 | 10 | 8 | - | 10 | 16 | 8 | No |
| combined | 74.5 | 4.9 x 14.7 x 2.7 | 24 | 26 | 26 | 51 | 26 | 51 | 28 | Yes |
| The Hibernia | 44 | 4.3 x 10.1 x 2.7 | 30 | 26 | 22 | 42 | - | 42 | 21 | Yes |
| The Aqueduct | 17.6 | 4.3 x 4.1 x 2.7 | 10 | 8 | - | - | - | 12 | 7 | No |
| combined | 61 | 4.3 x 14.2 x 2.7 | 32 | 28 | 30 | 72 | - | 72 | 28 | Yes |
| The Shannon | 94 | 6.5 x 14.5 x 2.7 | 60 | 32 | 55 | 100 | 36 | 110 | 47 | Yes |

FLOOR PLAN

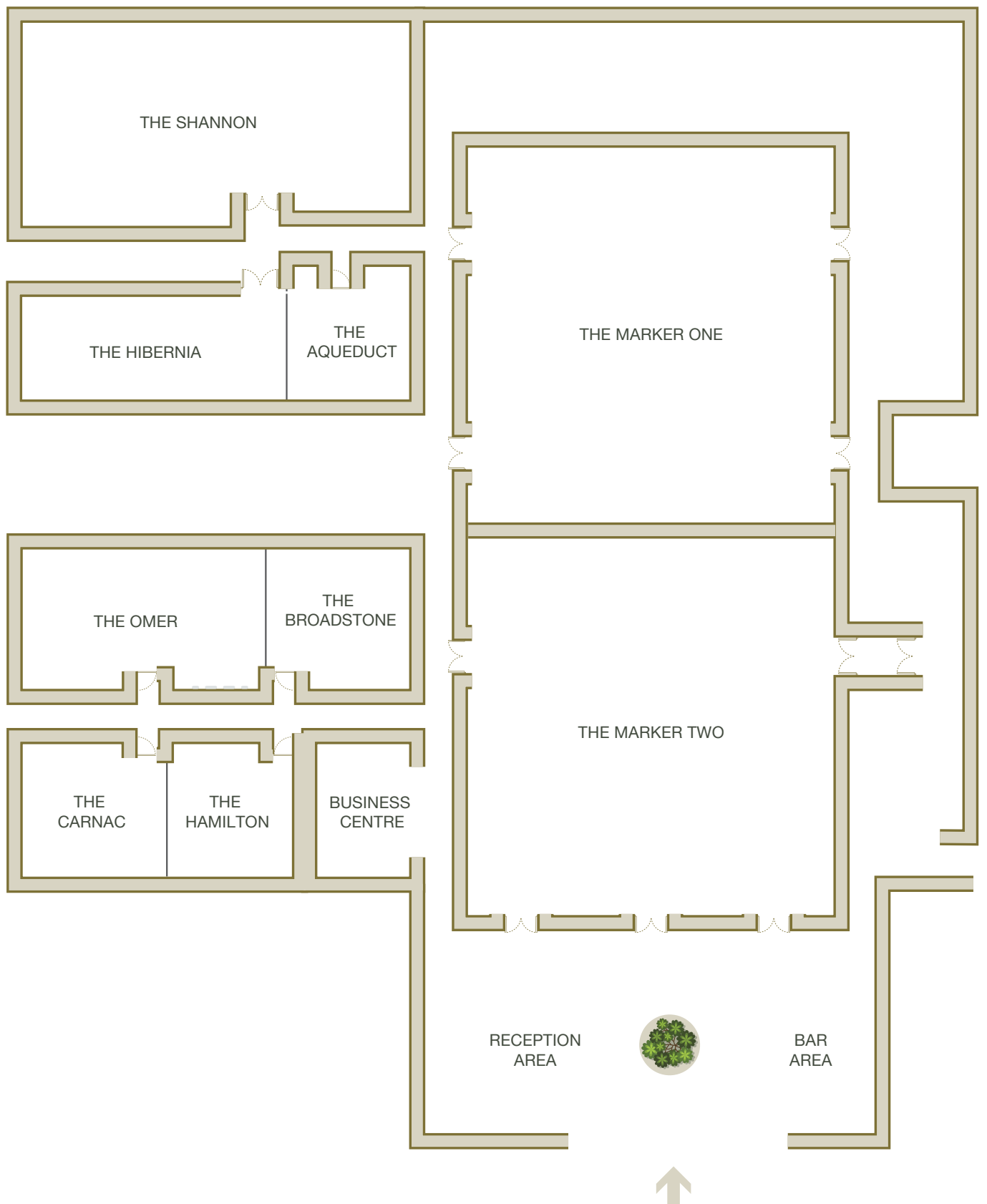



WEDDINGS AND SPECIAL OCCASIONS

At Anantara The Marker, wedding celebrations are stylish, intimate and utterly bespoke, with a team of planners and chefs to perfect your special day. Exchange vows on the rooftop as the sun sets over the city, or say “I Do” in one of the stylish indoor locations. From small, intimate, private gatherings for your nearest and dearest to lavish affairs for up to 240 guests, at Anantara The Marker we’ll ensure that your special day is just as individual as you.

We can assist to plan wonderful honeymoon experiences; a champagne breakfast in bed, a sensual spa journey, romantic picnic and candlelit dinner, or find out about once in a lifetime honeymoons at Anantara Hotels, Resorts & Spas across Europe and Asia, and other exotic destinations worldwide.

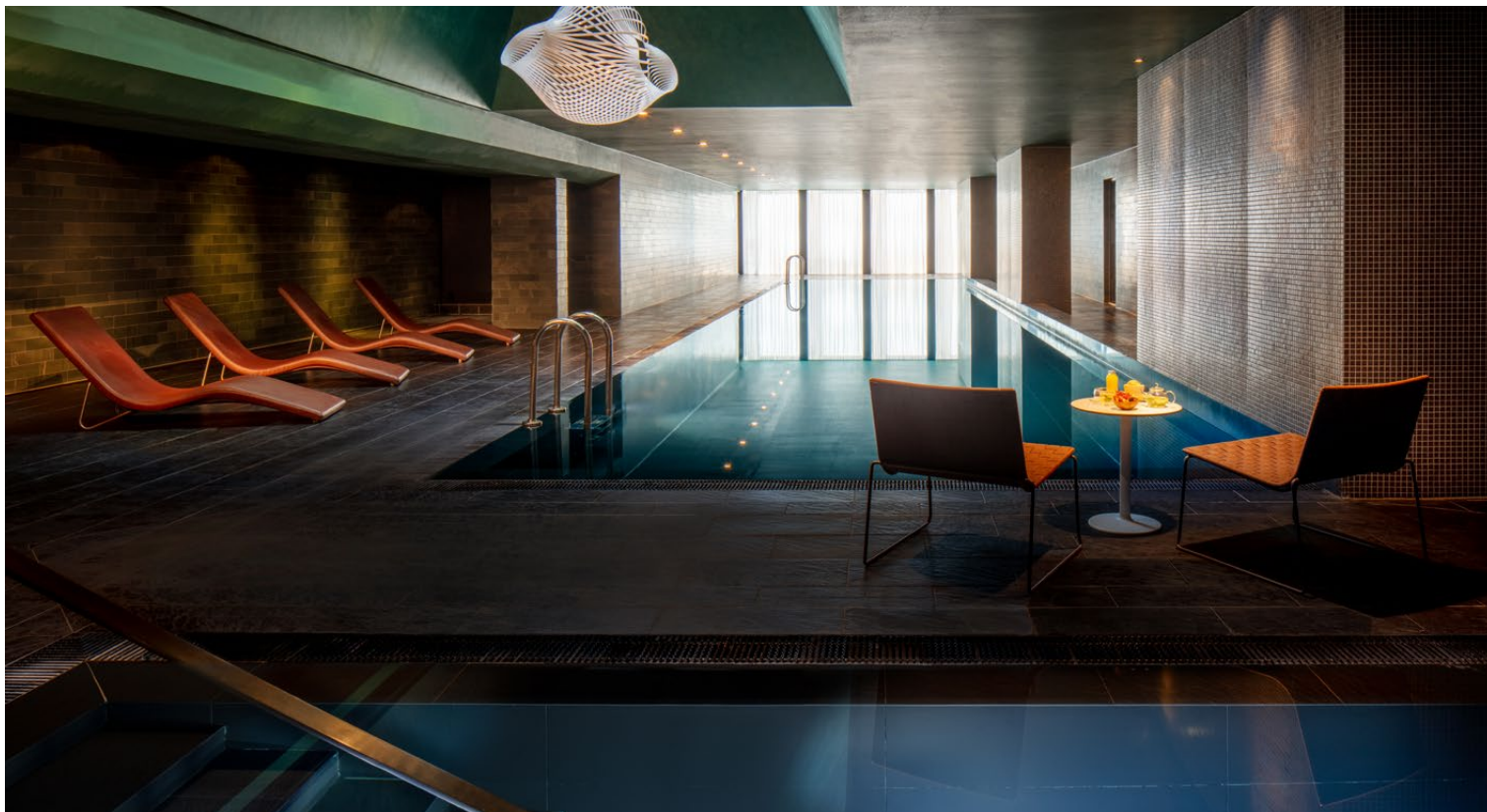

RECREATION AND LEISURE

Anantara The Marker embodies the ideal balance of bustling business hub and authentic city discovery. World class leisure facilities make relaxation a pleasure, while extensive business facilities make doing business easy.

At Anantara The Marker, we take a holistic approach to wellbeing, helping you lead a healthier lifestyle while still enjoying to the full. Start your day with a seasonal raw juice and energising waterside views. Salute the sun with yoga on the rooftop while you surround yourself with mountaintop views. Heal at the award-winning spa with therapies from East and West.

Hotel Leisure Facilities & Services

Time out from the city comes with ample choice at Anantara The Marker. A refreshing morning dip in the infinity pool and then going for a relaxing massage. Staying in shape with a workout or enjoying sunset cocktails at the Rooftop Lounge. For real culinary enthusiasts, Spice Spoons cooking school invites you to master Ireland's premium ingredients and unique flavours with an expert chef who is happy to share his secrets.

- The Anantara Spa with 5 treatment rooms
- 23 metre indoor infinity pool (75 feet)
- Jacuzzi
- Eucalyptus-infused steam room
- Sauna
- Relaxation areas
- Gym with personal training classes
- Courtesy Bicycles

Opening hours gym, pool & thermal area:

Monday - Friday: 6.00 am to 9.30 pm

Saturday, Sunday & Bank Holidays: 7.00 am to 8.00 pm



ANANTARA SPA

The award-winning and luxurious Spa at Anantara The Marker offers a haven of wellbeing in the middle of the city. The Spa facilities include five treatment rooms offering a range of body treatments and massages to help find balance based on the five elements. Beautify with advanced skincare from SkinCeuticals and Rejuvapen micro-needling.

Signature Spa Treatments

The Marker Dream (90 mins)

A luxurious coconut and herbal steam exfoliation on the back to help buff, hydrate and prepare the skin for the Marker massage. The Marker massage is a heavenly back massage treatment using the 'Tree of Life Balm' applied in a warm and enveloping sequence to help feed the skin with nutrients and help ease tight and tender muscles. The Marker facial treatment is customised to give your skin the perfect luminosity boost. To finish, your feet are pampered with a farewell foot ritual using a refreshing circulation serum to help reduce puffiness before ending with a blissful foot massage to rejuvenate tired and aching feet.

Elemental Herbology Five-Element Aroma Facial

Bespoke to each guest, this transformative facial combines healing botanicals, vitamins and marine extracts to replenish the skin and restore equilibrium, creating a more vibrant and healthy complexion.

Opening hours:

Monday – Friday: 11.30 am – 8.00 pm

Saturday: 9.30 am – 6.00 pm

Sunday: 10.00 am – 7.00 pm



LOCAL AREA EXCURSIONS

Our central location means that you can enjoy all the perks of a luxury hotel, yet you're never too far from the best-loved landmarks and attractions Dublin has to offer. Experience the exhilaration of a live rugby match at the Aviva Stadium, meander along the canal and immerse yourself in historic Dublin or enjoy a West End show at the Bord Gais Theatre opposite to the hotel.

Explore the vibrant Docklands and nearby cultural entertainment and historical sites.

- Bord Gáis Theatre
- Windmill lane recording studio
- EPIC The Irish Immigration Museum
- Convention Centre Dublin
- Trinity College Dublin
- St. Patrick's Cathedral
- National Gallery of Ireland
- Jameson Distillery Bow St.

AIRPORT TRANSFERS

Dublin Airport is approximately a 25-minute drive from the hotel and offers direct and connecting services to various destination worldwide. Private transfers can be arranged at the hotel.

- Dublin Airport (DUB) 12.5 KM
- Luas (tram) stop is Mayor Square 0.8KM
- Dublin Bus 0.1KM

Voltage 230 V, 50 Hertz

Currency Euro

Time Zone Winter GMT
Summer GMT +1

Climate Winter: November to January 7°C – 10°C (45°F – 50°F)
Spring: February to April 8°C – 12°C (46°F – 54°F)
Summer: May to July 17°C – 20°C (64°F – 68°F)
Autumn: August to October 14°C – 17°C (57°F – 64°F)

Special Holidays St Patrick's Day is a global celebration of Irish culture yearly on March 17. It particularly remembers St Patrick, one of Ireland's patron saints, who ministered Christianity in Ireland during the fifth century.



ANANTARA
THE MARKER • DUBLIN
HOTEL

A MEMBER OF



THE LEADING HOTELS
OF THE WORLD®

Anantara The Marker Dublin Hotel, Grand Canal Square, Docklands, Dublin 2, Ireland.
T +353 1 6875 100 E themarker@anantara-hotels.com